

STATE	PROJECT NUMBER	SHEET NO.	TOTAL SHEETS
GA.	EDS-565 (5)	1	13

SHT. 11A - ADDED - 5-6-91

DEPARTMENT OF TRANSPORTATION STATE OF GEORGIA

RIGHT OF WAY PROPOSED SYLVANIA BYPASS PARTIALLY LIMITED ACCESS

CONVENTIONAL SIGNS

STATE OR COUNTY LINE	---
CITY LIMIT LINE	---
PROPERTY LINE	---
SURVEY OR BASE LINE	---
RIGHT OF WAY LINE	EXISTING
	REQUIRED
	LIMIT OF ACCESS
R/W & LIMIT OF ACCESS	---
R/W MARKER	---
FENCE	X X
RAILROADS	---
POWER LINE	P P
TELEPHONE LINE	T T
POWER POLES	---
TELEPHONE OR TELEGRAPH POLES	---

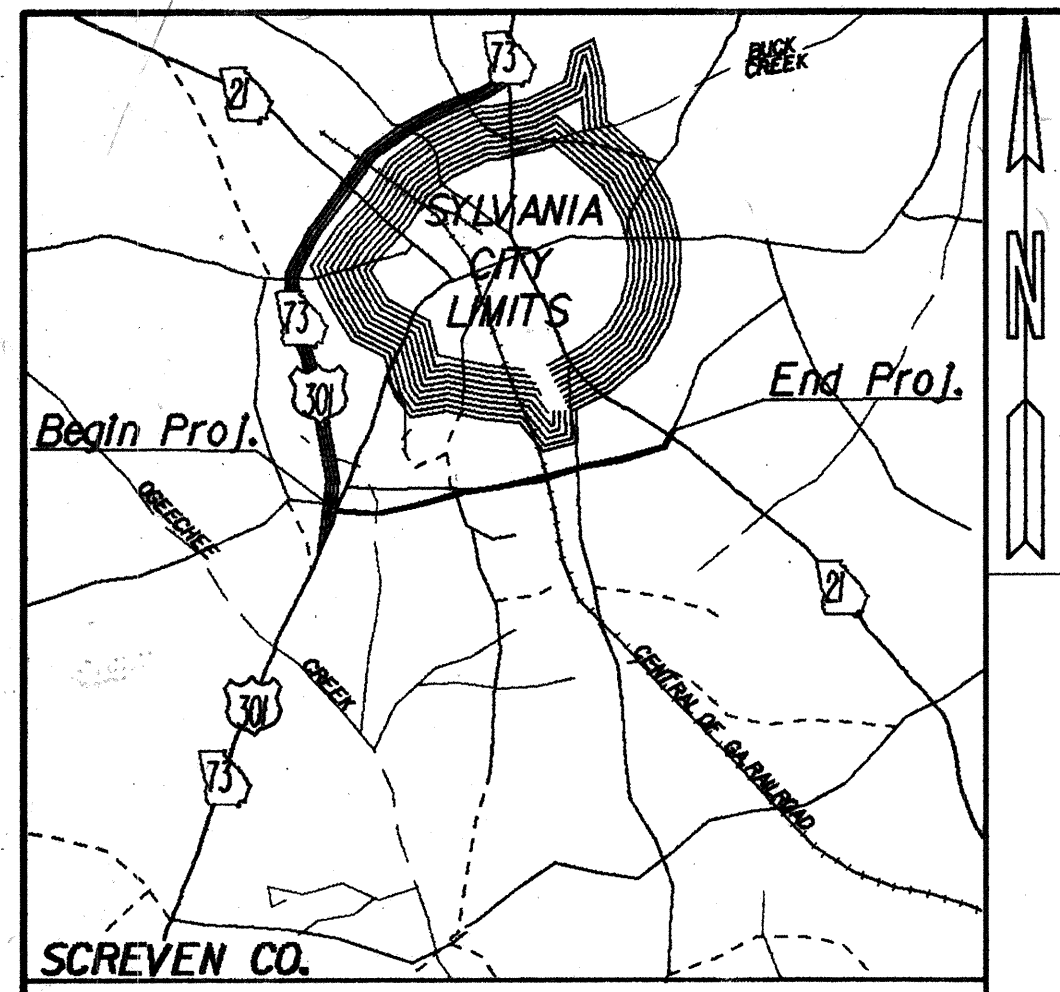

LOCATION SKETCH

FEDERAL AID PROJECT
SCREVEN COUNTY
EDS-565 (5)

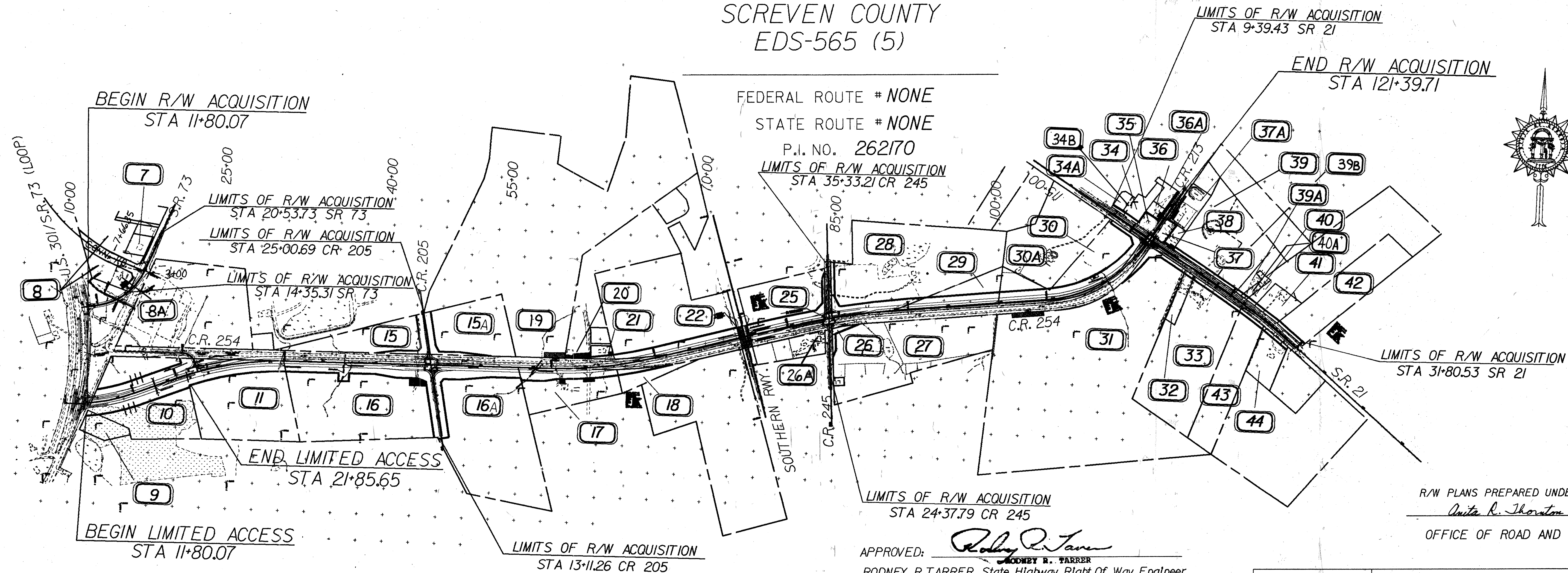

R/W PLANS PREPARED UNDER THE SUPERVISION OF
Anita R. Thornton
OFFICE OF ROAD AND AIRPORT DESIGN

APPROVED: *Rodney R. Tarrer*
RODNEY R. TARRER State Highway Right Of Way Engineer
DATE: Feb. 13, 1990

EDS-565 (5)
SCREVEN COUNTY
GMD 34

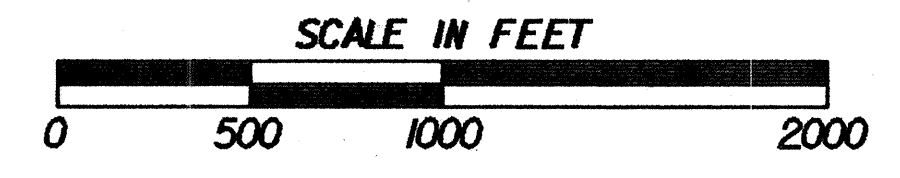

NOTE: ALL WORK TO BE DONE IN ACCORDANCE WITH THE STANDARD SPECIFICATIONS OF THE DEPARTMENT OF TRANSPORTATION OF GEORGIA CURRENT EDITION AS APPROVED BY THE FEDERAL HIGHWAY ADMINISTRATION

LENGTH OF RIGHT-OF-WAY PROJECT	2.076
	MILES
NET LENGTH OF RIGHT OF WAY	2.076
NET LENGTH OF EXCEPTIONS	0.000
GROSS LENGTH OF RIGHT OF WAY	2.076

DATE	STATE HIGHWAY ENGINEER
PLANS COMPLETED 01-30-1990	7-25-91 SHT. 8
REVISIONS 8-10-90 SHTS 6,7,8,9,11 & 13	11-21-91 SHT. 8 & 9
8-17-90 SHTS 6,7,9,10 & 13	12-5-91 SHT. 6 & 13
9-20-90 SHT. 9	12-12-91 SHT. 11 & 11A
10-2-90 SHTS 3,4,5, & 12	1-24-92 SHT. 6, 11, 11A, 13
4-18-91 SHT. 10	2-20-92 SHT. 6
5-6-91 SHTS 2,8,11 & 11A	
7-1-91 SHT. 2,6,7,8,9 & 13	
7-3-91 SHT. 10	
12-FEB-1990 05:52	ZG2: [202, 111] 262170RC1.DGN